



**MODEL** YAMAHA XT 660 X / R

**YEAR** 2004-->

**LINE** SPORT

**MUFFLER** OVAL CARBON CAP

**SCHEMATIC**

**ELENCO PARTI / PARTS LIST**

#	QTÀ / QTY	DESCRIZIONE / DESCRIPTION	CODICE / CODE
1	2	DB killer / DB killer	50.DK.021.0
2	2	Silenziatore / Muffler	OVAL CARBON CAP
3	4	Protezione in gomma per staffa / Rubber protection for bracket	50.73.077.1
4	4	Staffa / Bracket	50.SS.030.0
5	4	Vite M8x50 / Screw M8x50	50.73.074.1
6	4	Rondella in alluminio / Aluminium washer	50.73.063.1
7	2	Distanziale in alluminio 35mm / Aluminium spacer 35mm	50.SS.054.1
8	2	Distanziale in alluminio 30mm / Aluminium spacer 30mm	50.SS.053.1
9	1	Tubo di raccordo sinistro / Left link pipe	9773Y017S3SX
10	1	Tubo di raccordo destro / Right link pipe	9773Y017S3DX
11	2	Fascetta Ø 34/37 mm / Pipe clamp Ø 34/37 mm	50.FA.002.1
12	2	Molla lunga / Long spring	50.71.080.1
13	2	Tubo in gomma per molla / Rubber pipe for spring	50.73.210.1

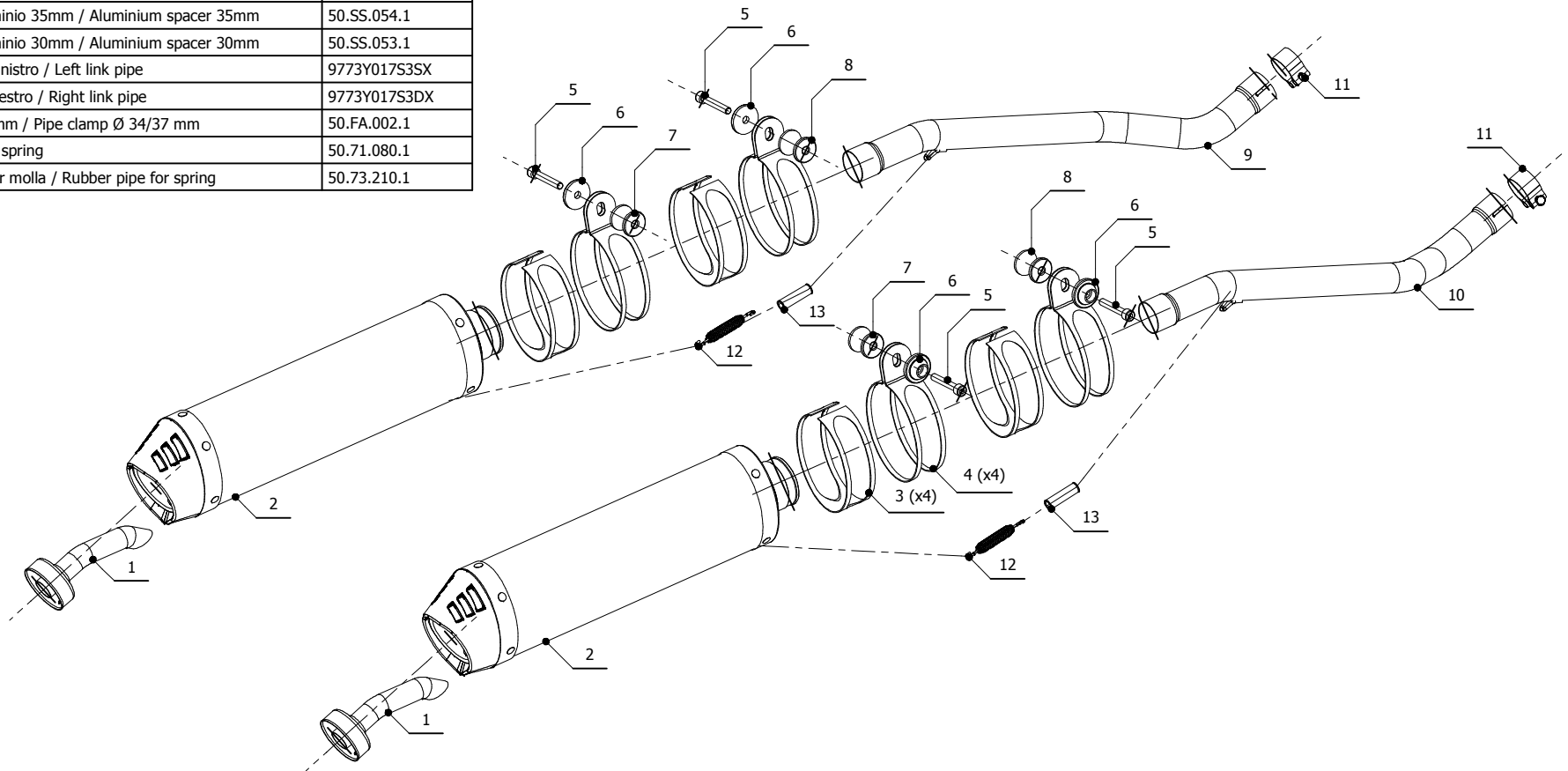

**APPLICAZIONI / APPLICATIONS**

CODICE / CODE	TUBO / PIPE	SILENZIATORE / MUFFLER	FASCETTA / CLAMP	CODICE OMOL. / HOMOL.CODE
Y.017.L3C	INOX / ST.STEEL	CARBONIO (COPPA CARBONIO) / CARBON (CARBON CAP)	INOX / ST.STEEL	ME040 e9 1308
Y.017.L4C	INOX / ST.STEEL	TITANIO (COPPA CARBONIO) / TITANIUM (CARBON CAP)	INOX / ST.STEEL	ME040 e9 1308